

OWNER'S MANUAL

ATX-GMX-2000

ATX® Multigym GMX2000

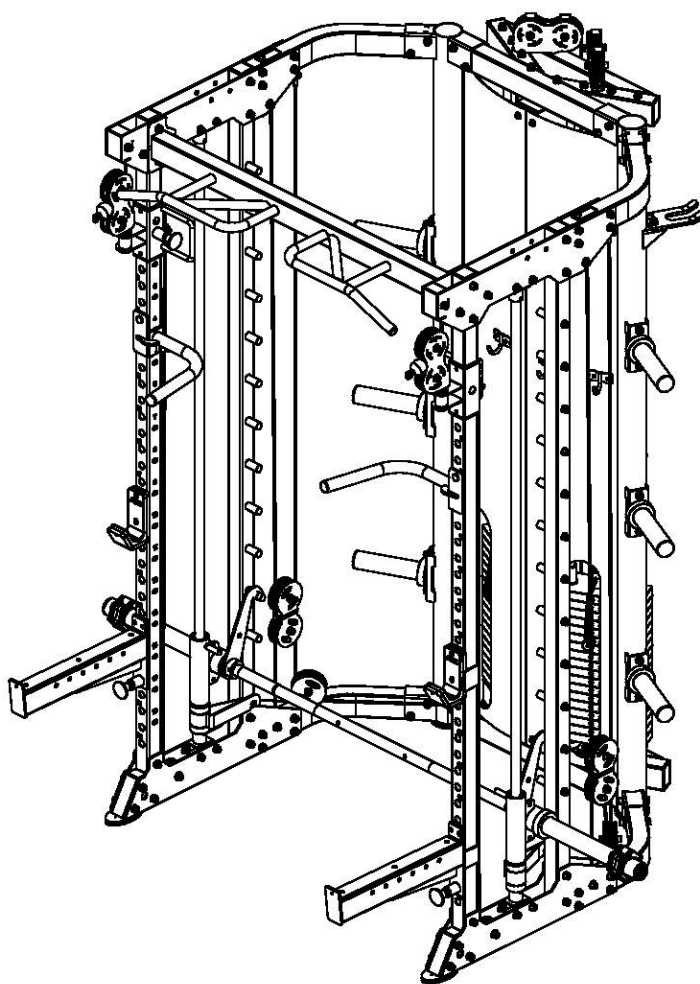

CAUTION: Read all precautions and instructions before using this equipment. Save this manual for future reference.

CONTENTS

02 General warnings and maintenance advice

03-14 Assembly Instructions

Explained as a series of steps, with each step containing:

- Pictures, descriptions and quantities of the parts required
- Notes
- Diagram showing how the parts fit together

15-16 Part List

Assembly Instructions

Before Your Begin

This exercise equipment is built for optimum safety. Be sure to read the entire manual before you assemble or operate your equipment. Please note the following safety precautions:

1. Keep children and pets away from the equipment at all times. Do not leave children unattended in the same room with the equipment.
2. Only one person at a time should use the equipment.
3. If the user experiences dizziness, nausea, chest pain, or any other abnormal symptoms STOP the workout at once. CONSULT A PHYSICIAN IMMEDIATELY.
4. Position the equipment on a clear, level surface. DO NOT use the equipment near water or outdoors.
5. Keep hands away from all moving parts.
6. Always wear appropriate workout clothing when exercising. DO NOT wear robes or other clothing that could become caught in the equipment.
7. Use the equipment only for its intended use as described in this manual. DO NOT use attachments not recommended by the manufacturer.
8. Before using the equipment, always do stretching exercises to properly warm up.
9. Never operate the equipment if the equipment is not functioning properly.

INFORMATION

- We recommend you have someone assist you in lifting and assembling your gym.
- Follow these steps carefully and it will make it easier to assemble your gym.

STEP 1

NOTE:

- All the washer and nuts which are not marked are W10 and N10.

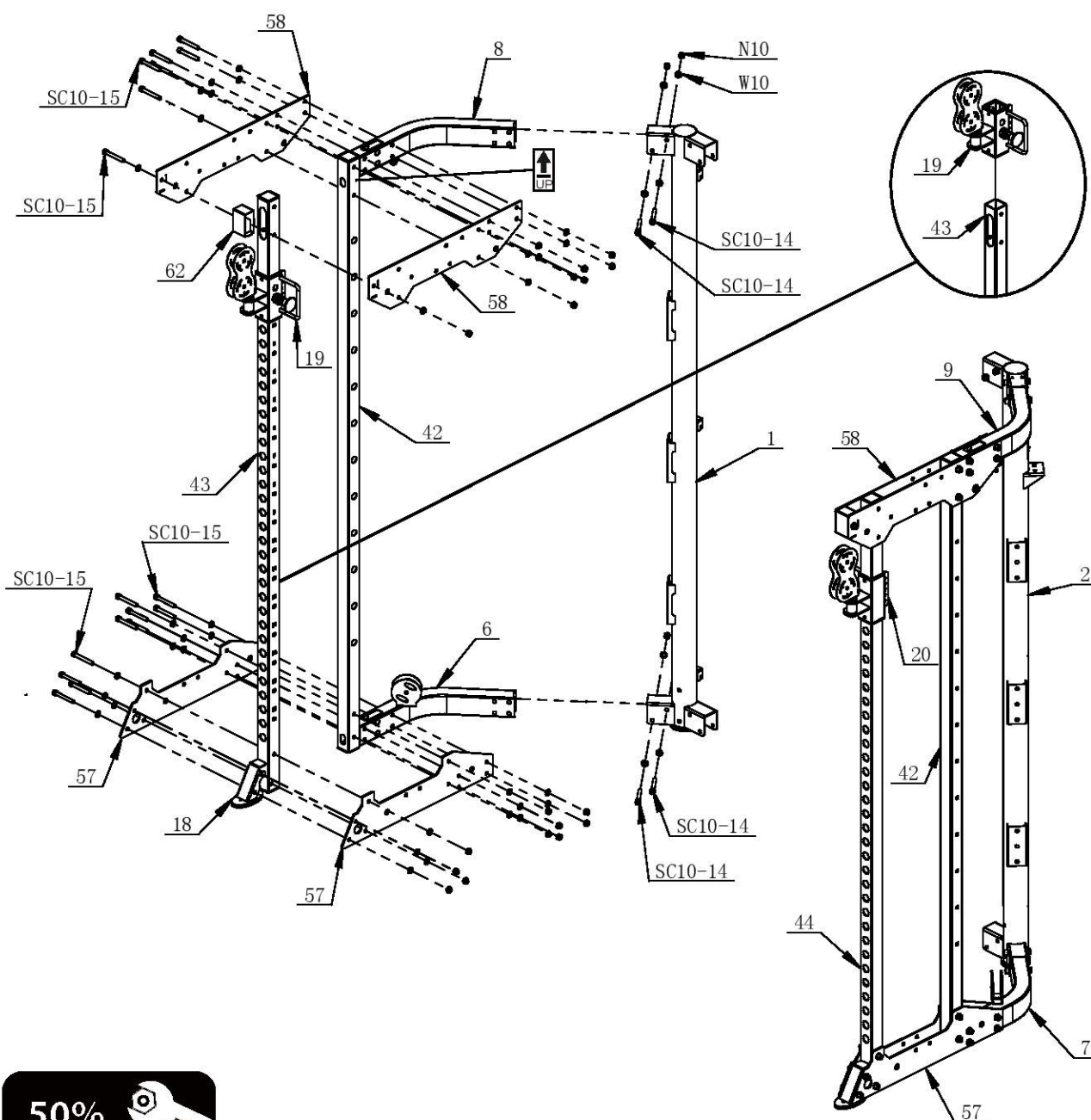

50%



INFORMATION

- We recommend you have someone assist you in lifting and assembling your gym.
- Follow these steps carefully and it will make it easier to assemble your gym.

STEP 2

NOTE:

- All the washer and nuts which are not marked are W10 and N10.

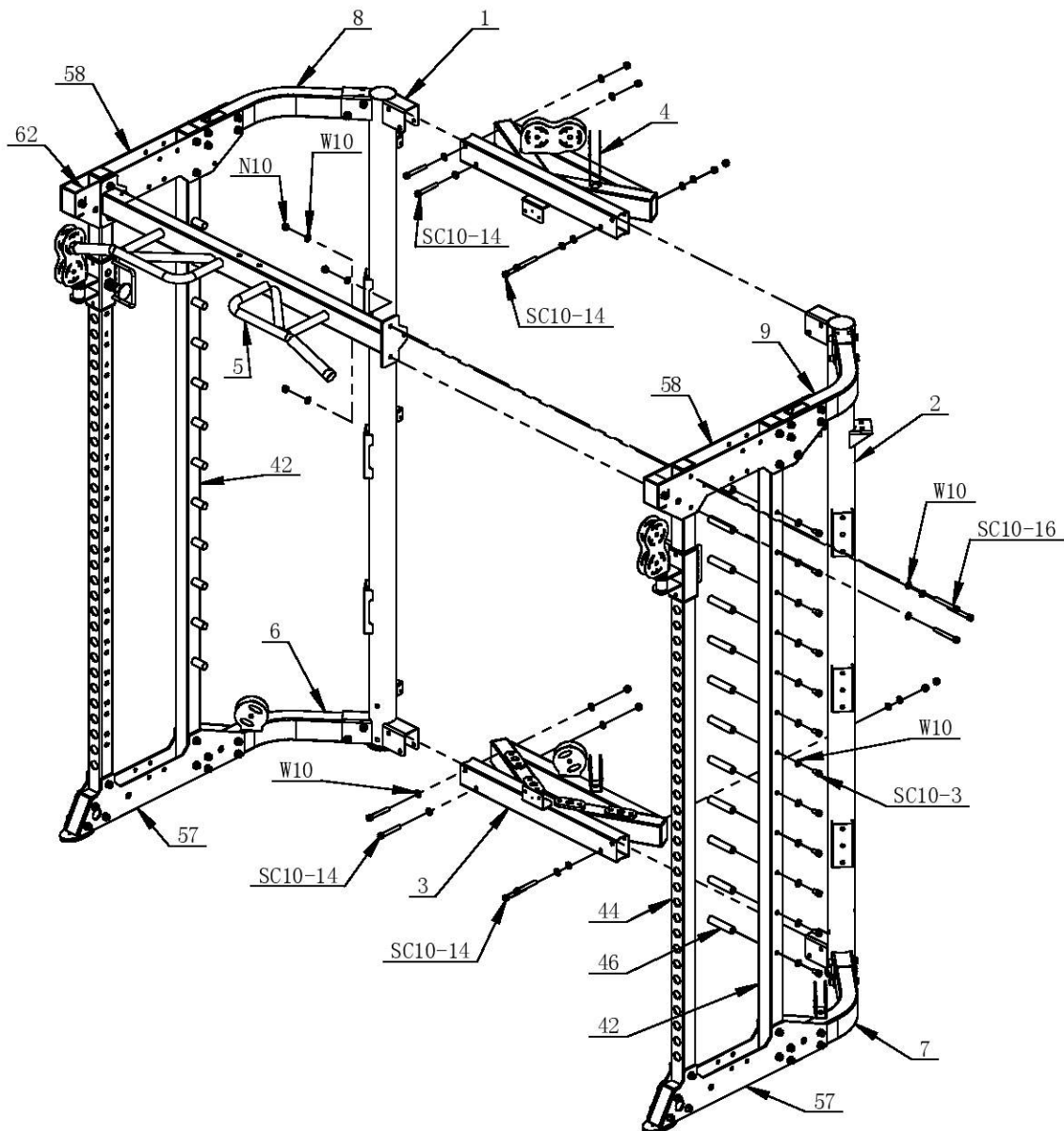

50%



INFORMATION

- We recommend you have someone assist you in lifting and assembling your gym.
- Follow these steps carefully and it will make it easier to assemble your gym.

STEP 3

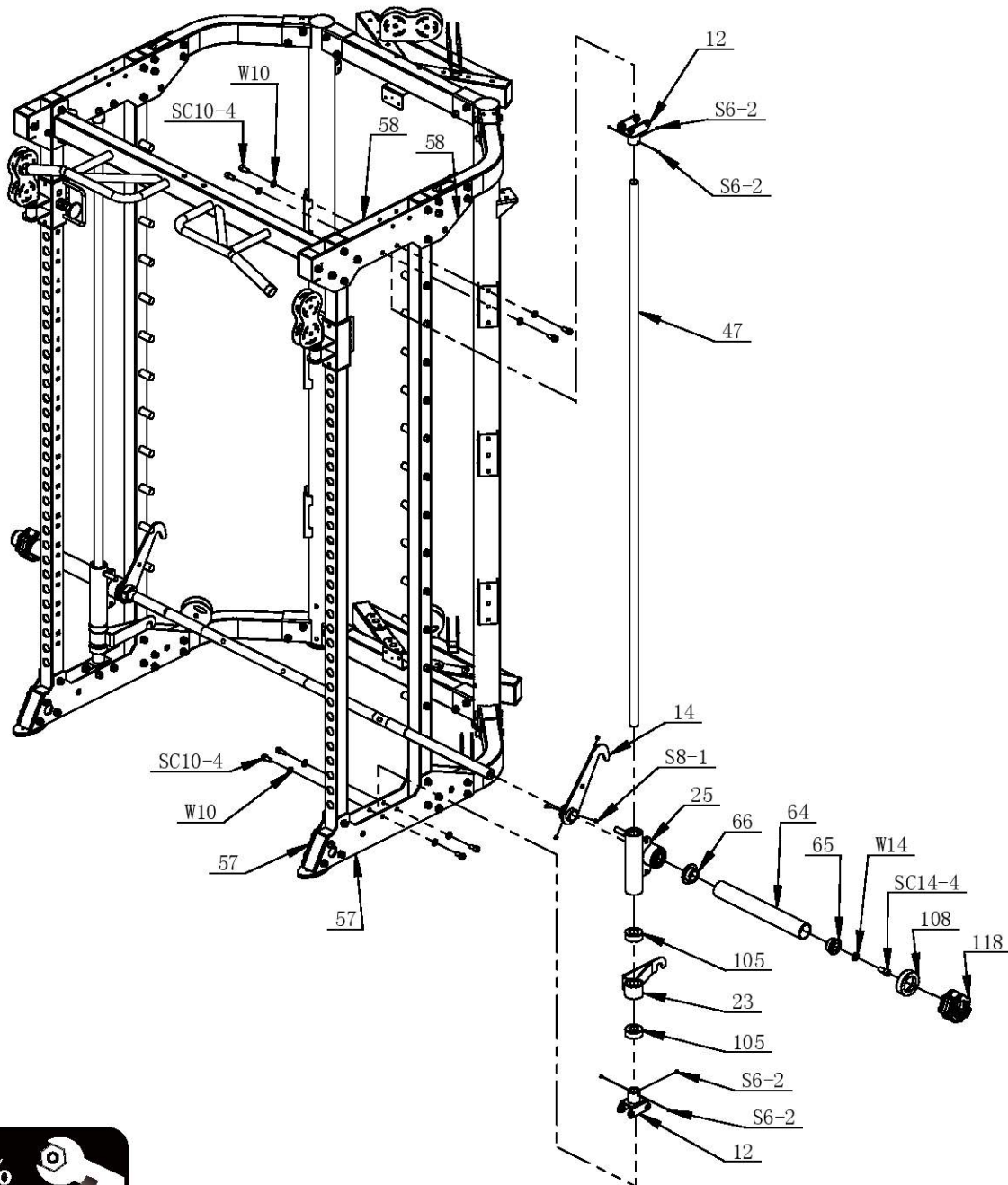

50%



INFORMATION

- We recommend you have someone assist you in lifting and assembling your gym.
- Follow these steps carefully and it will make it easier to assemble your gym.

STEP 4

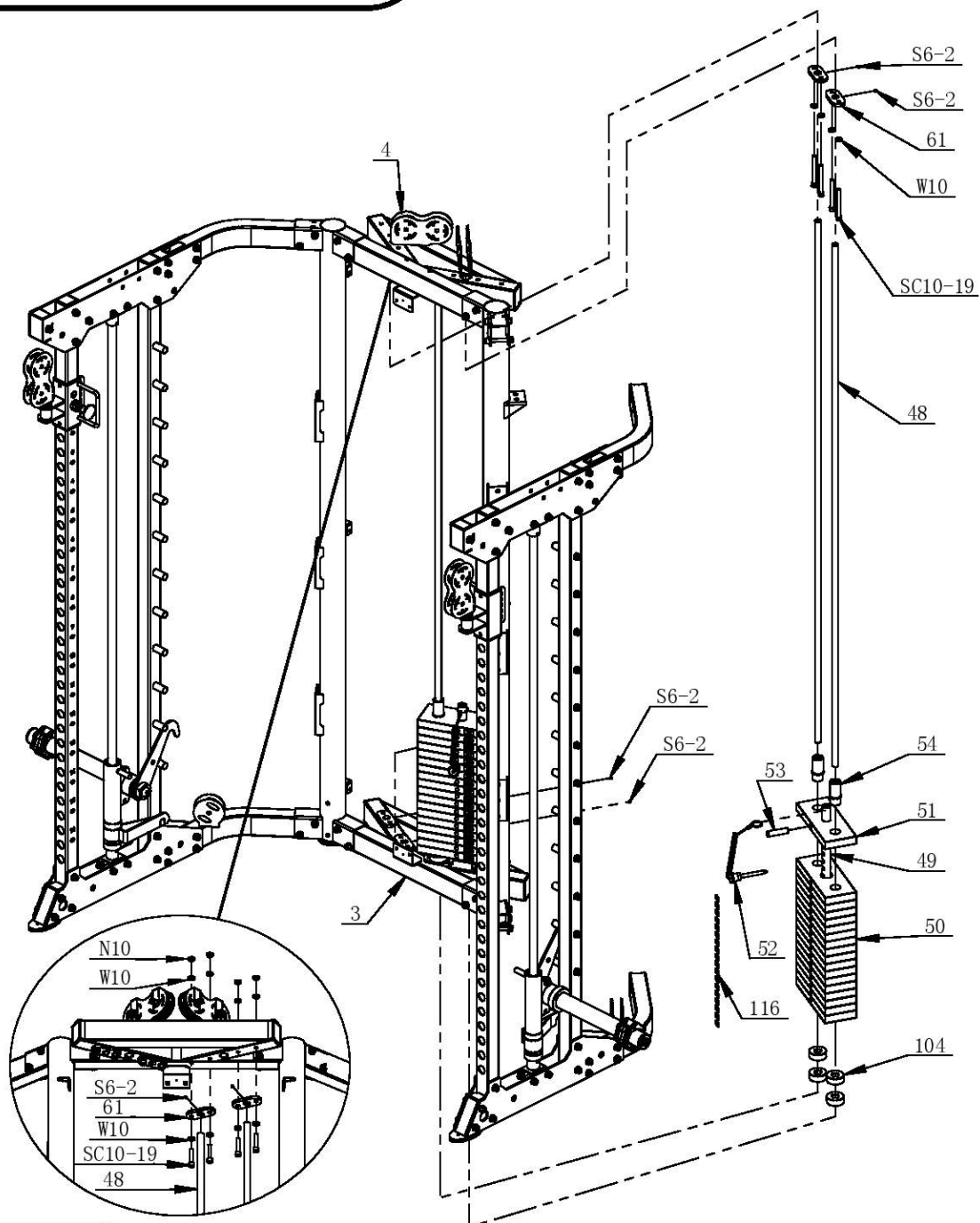

50%



INFORMATION

- We recommend you have someone assist you in lifting and assembling your gym.
- Follow these steps carefully and it will make it easier to assemble your gym.

STEP 5

NOTE:

- All the washer and nuts which are not marked are W10 and N10.

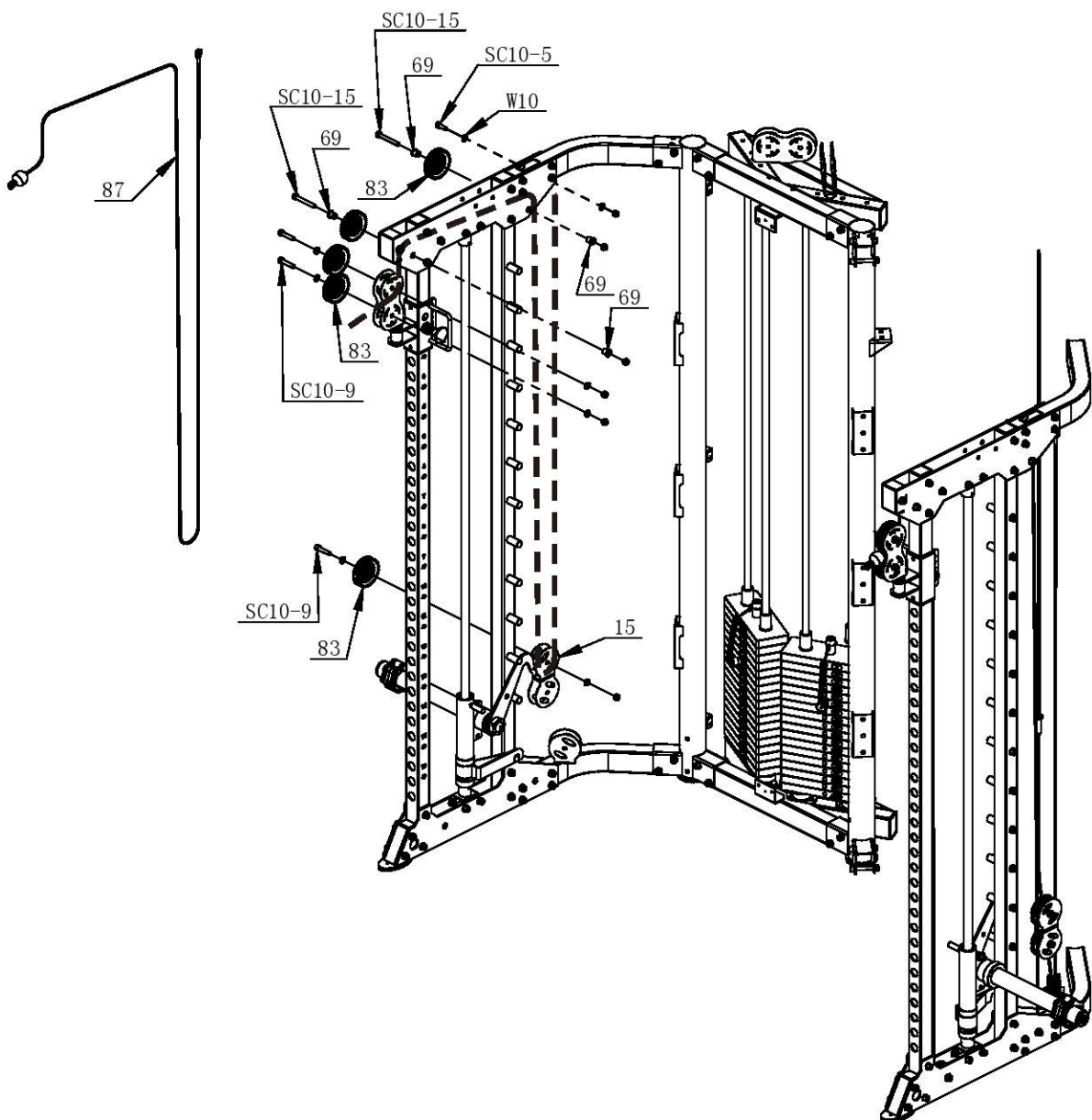

50%



INFORMATION

- We recommend you have someone assist you in lifting and assembling your gym.
- Follow these steps carefully and it will make it easier to assemble your gym.

STEP 6

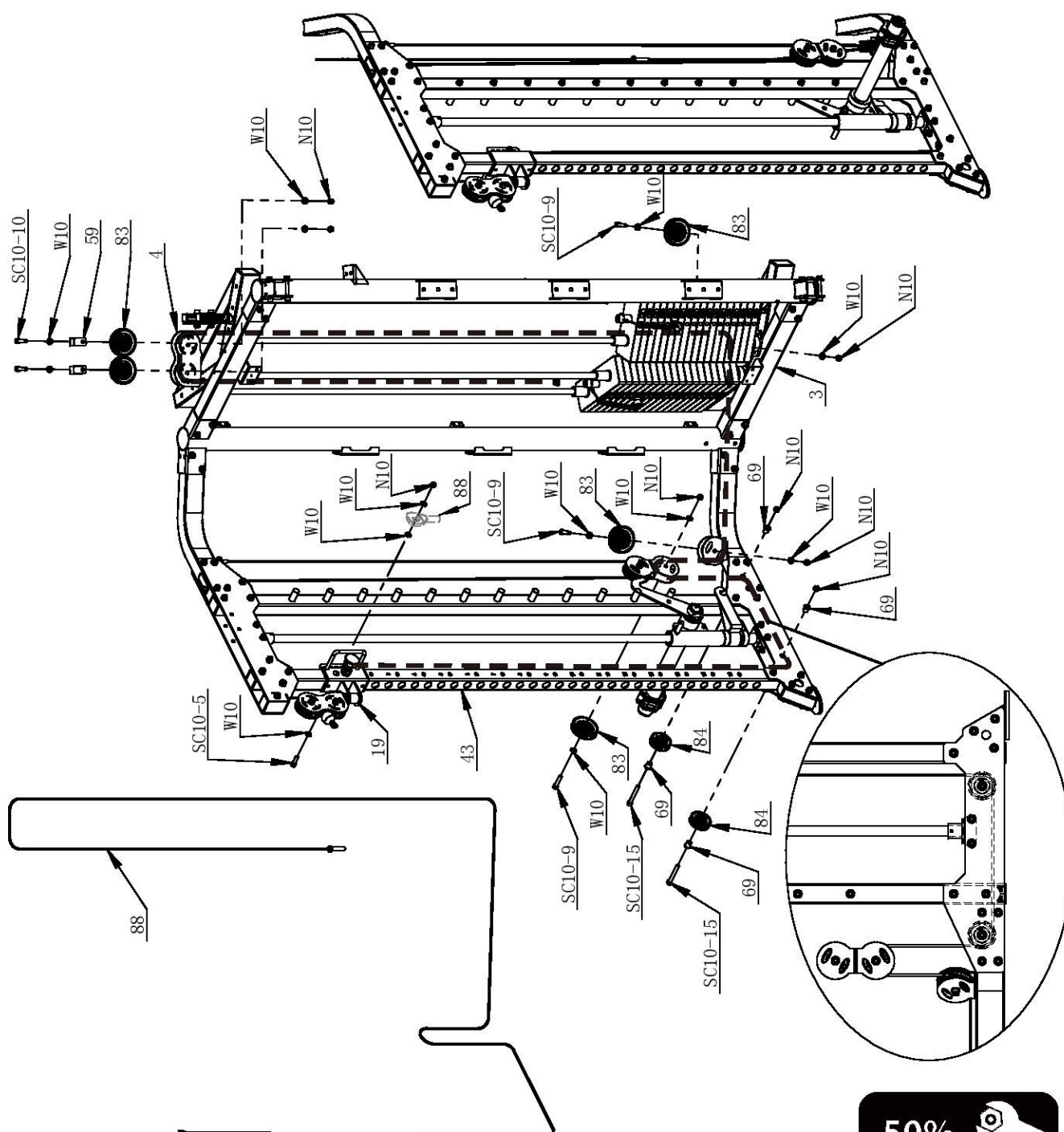

INFORMATION

- We recommend you have someone assist you in lifting and assembling your gym.
- Follow these steps carefully and it will make it easier to assemble your gym.

STEP 7

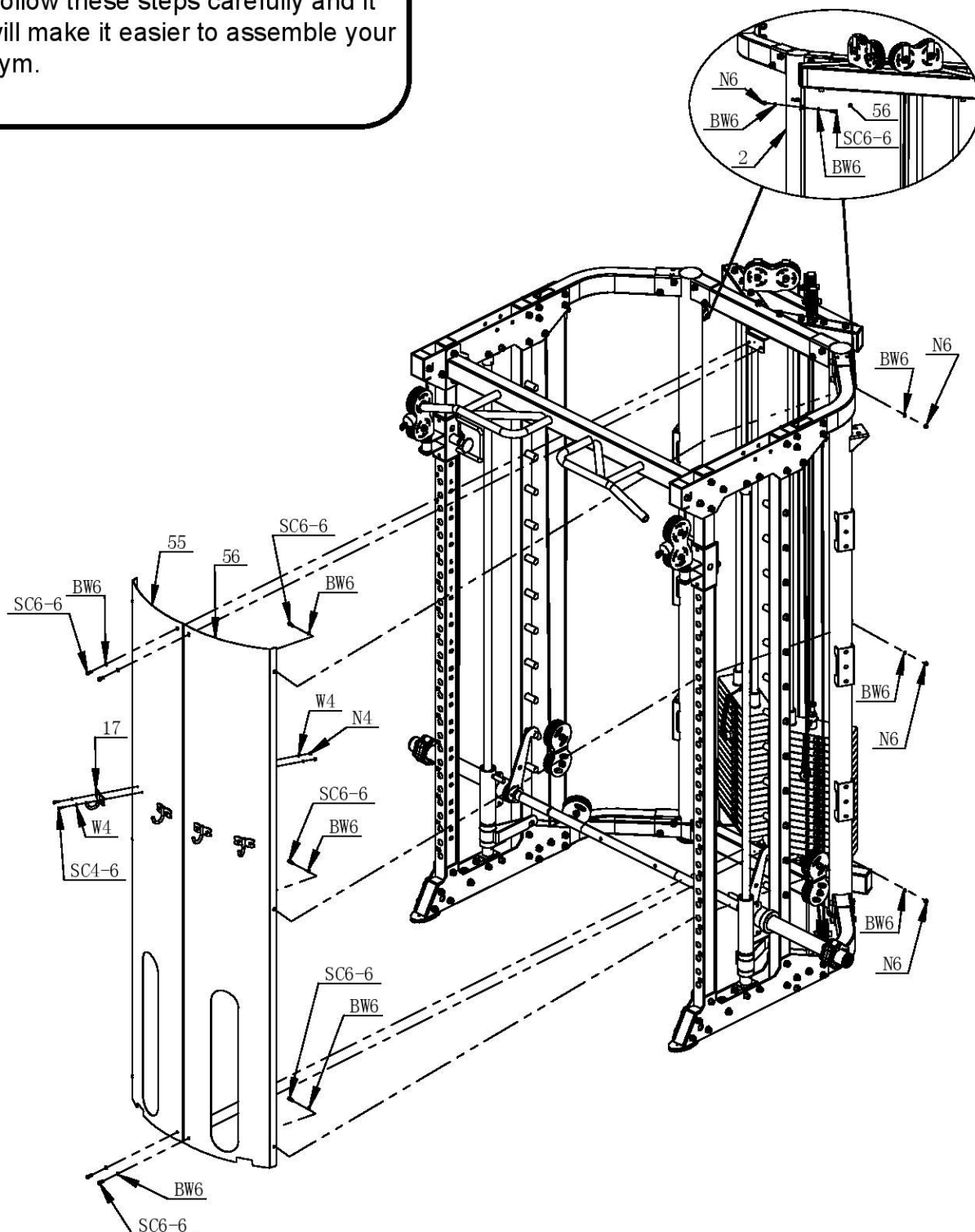

50%



INFORMATION

- We recommend you have someone assist you in lifting and assembling your gym.
- Follow these steps carefully and it will make it easier to assemble your gym.

STEP 8

NOTE:

- All the washer and nuts which are not marked are W10 and N10.

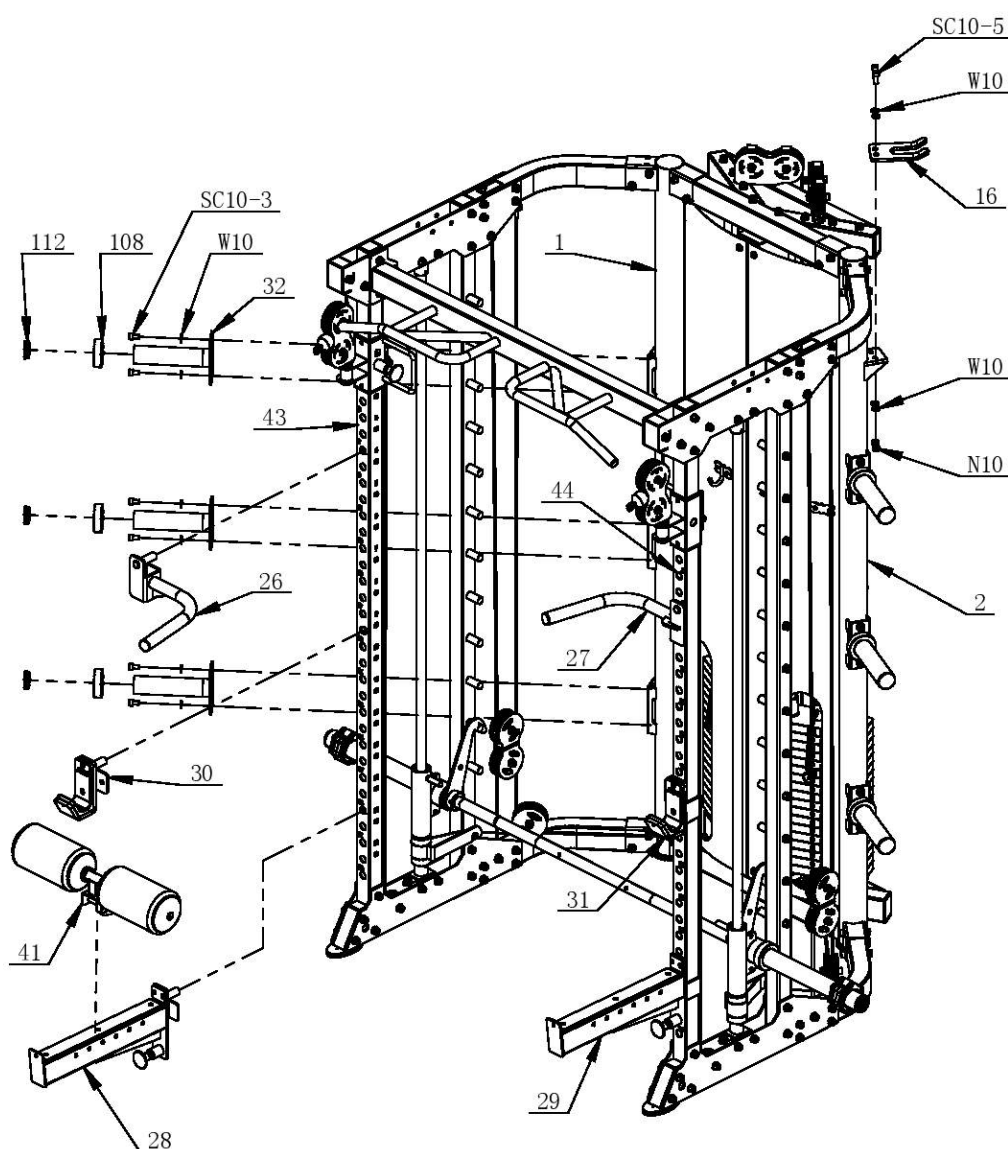

100%



STEP 9

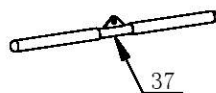
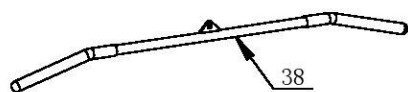
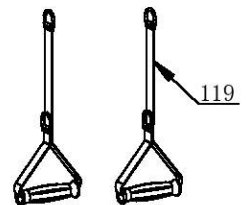
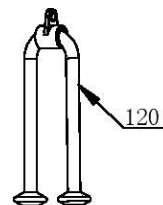
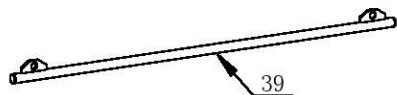
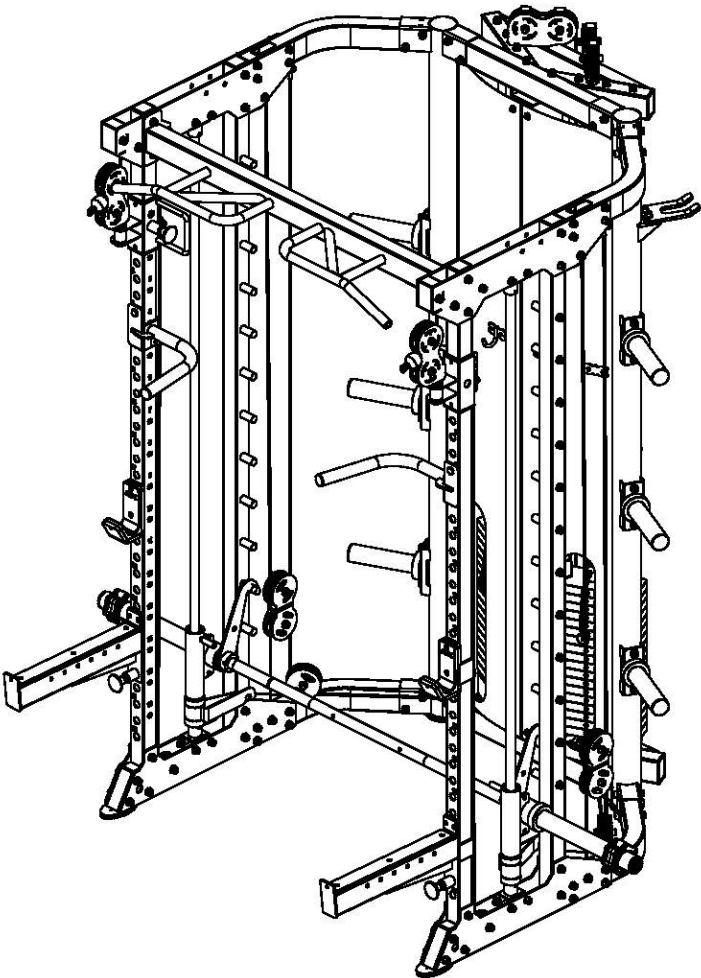

PRE-ASSEMBLY

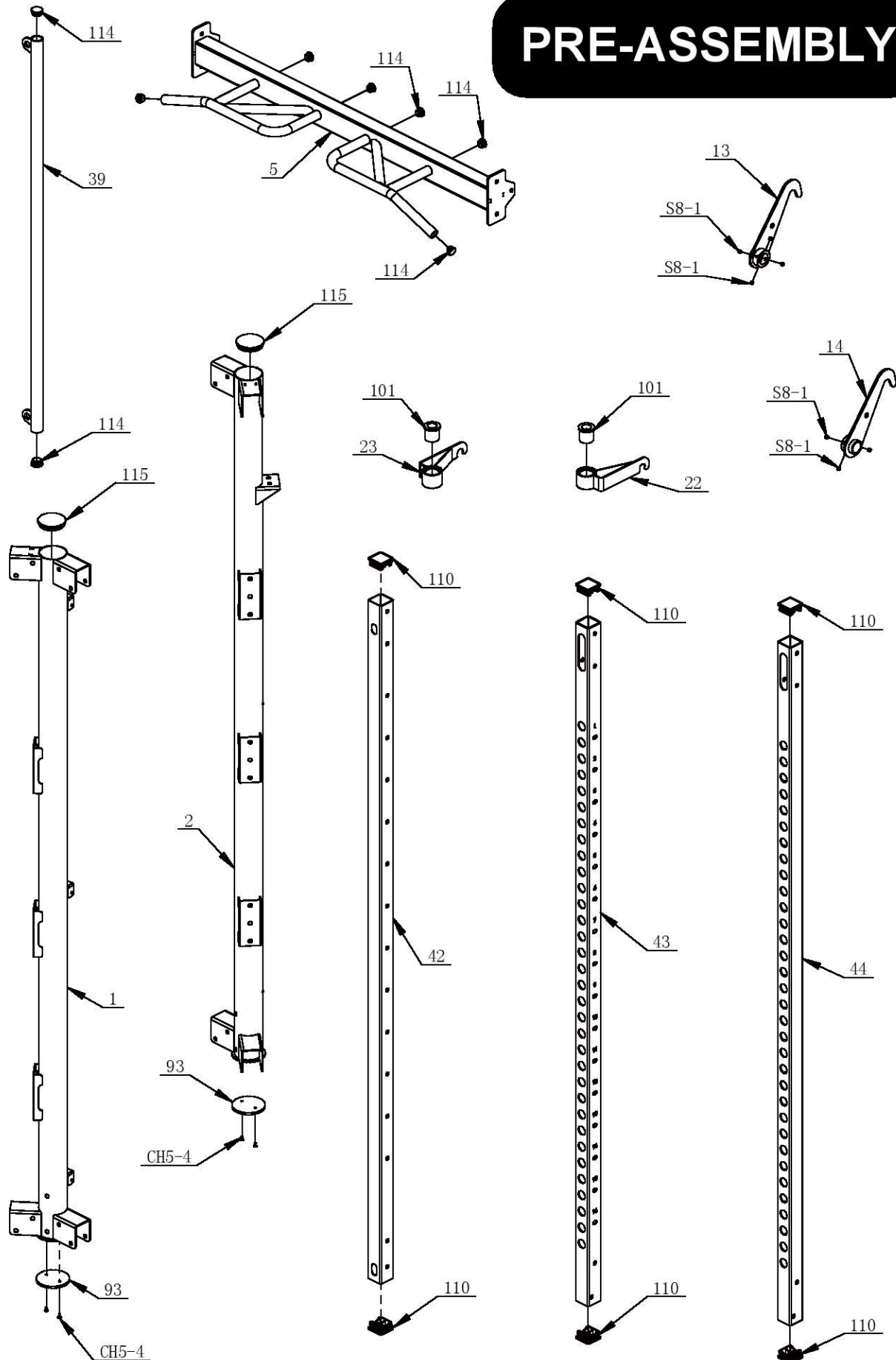

PRE-ASSEMBLY

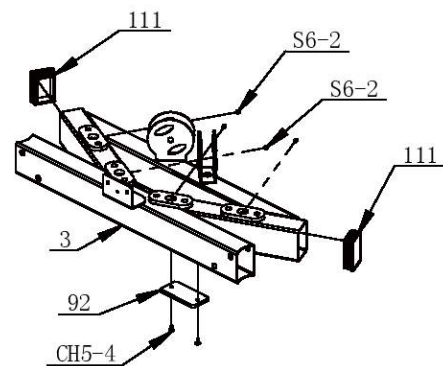
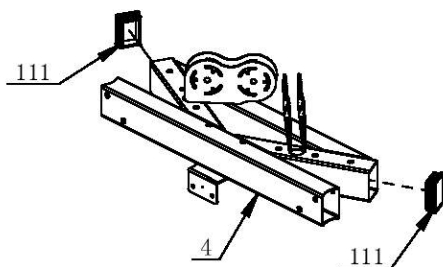
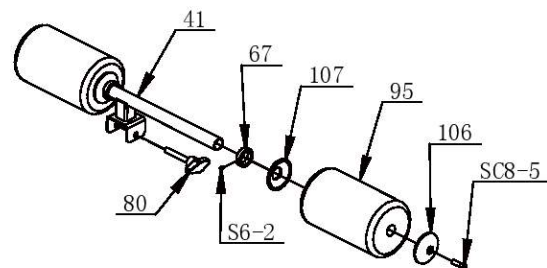
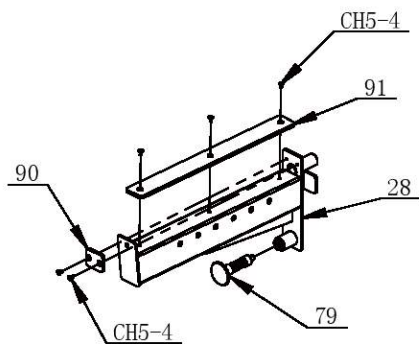
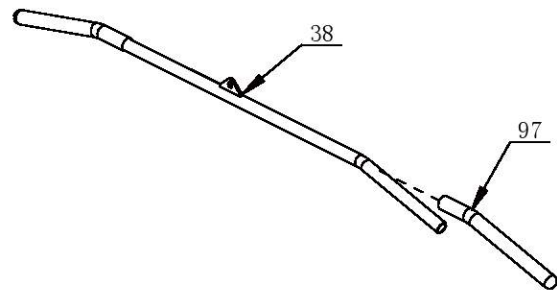
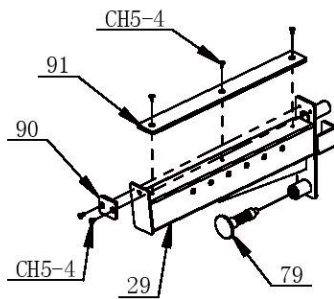
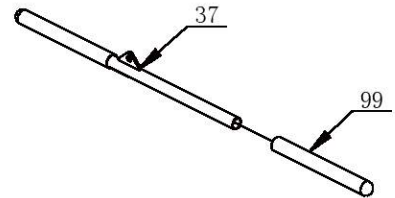
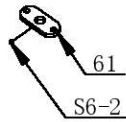
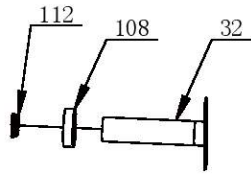

PRE-ASSEMBLY

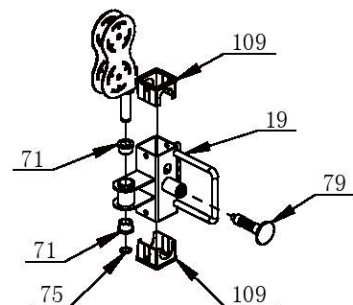
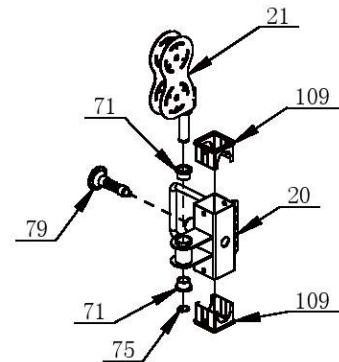
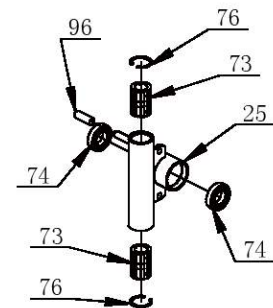
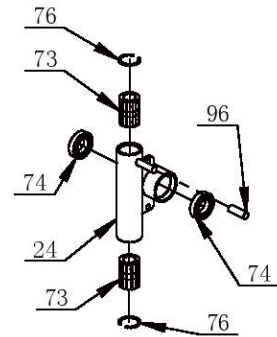
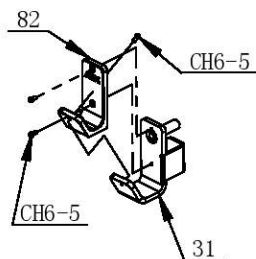
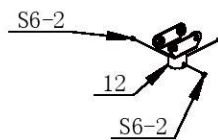
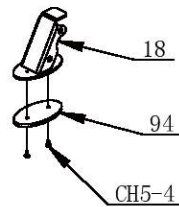
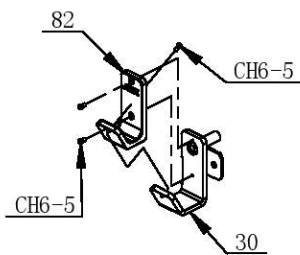
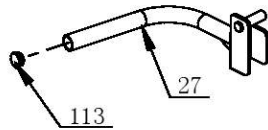
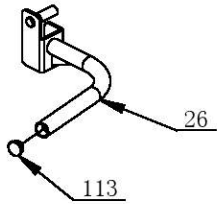

PARTS LIST

PART#	DESCRIPTION	QTY
1	Back Riser Group Right	1
2	Back Riser Group Left	1
3	Upper link Group	1
4	Lower link Group	1
5	Pull Up Group	1
6	Curved link Group 1	1
7	Curved link Group 2	1
8	Curved link Group 3	1
9	Curved link Group 4	1
10	*	*
11	*	*
12	Guide Rod Connecting Group	4
13	Right Hook Frame	1
14	Left Hook Frame	1
15	Double Pulley Housing	2
16	Placing Plate	1
17	Hook	4
18	Anchor Plate	2
19	Right Adjusting Bushing	1
20	Left Adjusting Bushing	1
21	Swing Pulley Housing	2
22	Right Safety Hook	1
23	Left Safety Hook	1
24	Right Guide Tube Frame	1
25	Left Guide Tube Frame	1
26	Right Parallel bar Frame	1
27	Left Parallel bar Frame	1
28	Right Safety Frame	1
29	Left Safety Frame	1
30	Right Hook Frame	1
31	Left Hook Frame	1
32	Barbell Hanging Frame	6
33	*	*
34	*	*
35	*	*
36	*	*
37	Short Pull Rod	1
38	Long Pull Rod	1
39	Double hole Pull Rod	1
40	*	*
41	Foam Roller Frame	1
42	Side Upright Frame	2
43	Right Front Upright Tube	1
44	Left Front Upright Tube	1
45	Barbell Rod	1
46	Hanging Post	24
47	Barbell Rod Guide Rod	2
48	Guide Rod	4

PART#	DESCRIPTION	QTY
49	Selector	2
50	5KG Weight Stack	34
51	5KG Weight Stack Head	2
52	Wt Selector Pin	2
53	Spring Pin	2
54	Guide Rod Bushing	4
55	Shield 1	1
56	Shield 2	1
57	Connecting Plate 3	4
58	Connecting Plate 2	4
59	L Protect Plate	4
60	*	*
61	Guide Rod Fixing Plate	4
62	Block Tube	2
63	*	*
64	Olympic Bushing	2
65	Olympic Bushing Cap	2
66	Olympic Bushing Ring	2
67	Foam Roller Ring	2
68	*	*
69	Pulley Bushing	16
70	*	*
71	D32 Bushing	4
72	*	*
73	Linear Bearing	4
74	Bearing 6006	4
75	Shaft Retaining Ring	2
76	Hole Retaining Ring	4
77	Shrapnel Nut	2
78	*	*
79	Pin 1	4
80	T Pin	1
81	*	*
82	U Plastic Plate	2
83	89 Pulley	20
84	70 Pulley	4
85	*	*
86	*	*
87	Cable 1	2
88	Cable 3	2
89	*	*
90	Plastic Plate 1	2
91	Plastic Plate 2	2
92	Plastic Plate 3	1
93	Plastic Plate 4	2
94	Plastic Plate 5	2
95	Foam Roller	2
96	Plastic Pip	2

PARTS LIST

PART#	DESCRIPTION	QTY
97	Grip 4	2
98	*	*
99	Grip 3	2
100	*	*
101	D32 Plastic Bushing	2
102	*	*
103	*	*
104	D20.5 Buffer	8
105	D25.5 Buffer	4
106	Foam Roller Cap 1	2
107	Foam Roller Cap 2	2
108	Barbell Spacer Bushing	8
109	F60 Plastic Bushing	4
110	F50x50 Cap	8
111	F50x70 Cap	4
112	D48 Cap	6
113	D32 Cap	2
114	D25 Cap	8
115	D76 Cap	2
116	Weight Stack Label	2
117	Clip	5
118	Barbell Clasp	2
119	Long Strap Handle	2
120	Triceps Rope	1
121	Chain	2
FN12	Flange Nut M12	2
W4	Washer Φ 4	16
BW6	Big Washer Φ 6	16
W10	Washer Φ 10	226
W14	Washer Φ 14	2
N4	Nut M4	8
N6	Nut M6	6
N10	Nut M10	94
CH6-5	Countersunk Head Screw M6X12	6
S6-2	Socket Set Screw M6X6	22
S8-1	Socket Set Screw M8X8	8
CH5-4	Countersunk Head Screw M5X10	20
SC4-6	Socket Cap Screw M4X12	8
SC6-6	Socket Cap Screw M6X15	10
SC8-5	Socket Cap Screw M8X25	2
SC10-3	Socket Cap Screw M10X16	36
SC10-4	Socket Cap Screw M10X20	16
SC10-5	Socket Cap Screw M10X25	6
SC10-9	Socket Cap Screw M10X45	12
SC10-10	Socket Cap Screw M10X50	4
SC10-14	Socket Cap Screw M10X70	16
SC10-15	Socket Cap Screw M10X75	42
SC10-16	Socket Cap Screw M10X80	6

PART#	DESCRIPTION	QTY
SC10-19	Socket Cap Screw M10X95	8
SC14-5	Socket Cap Screw M14X20	2